

To order items on this page — full catalog number requires prefix

POWERS PROCESS CONTROLS

Hydroguard 427 and 428 Mixing Valves —

6 Maximum temperature setting.

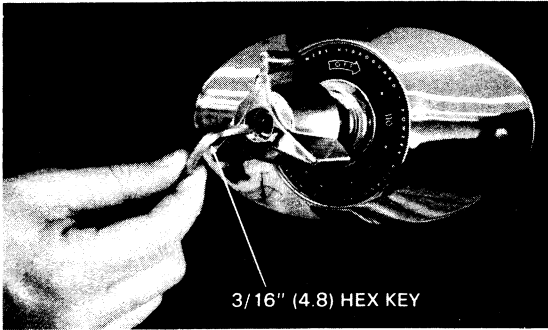

Concealed Maximum Temperature Setting. The standard 427/428 Hydroguard is factory set to deliver tempered water up to a maximum temperature of 115°F (46°C) with equal supply pressures, hot water temperature 140°F (60°C), cold water temperature 60°F (16°C). If desired, the concealed maximum temperature setting can be raised or lowered as follows:

1. Turn HANDLE completely counter-clockwise to deliver water at maximum temperature.
2. Remove HANDLE RETAINING SCREW and the LOCK SCREW located inside the TEMPERATURE ADJUSTMENT STEM with a 3/16" (4.8) hex key.
3. With the same hex key, turn the MAXIMUM TEMPERATURE ADJUSTMENT SCREW clockwise for a lower temperature and counterclockwise for a higher temperature.

CAUTION: Resetting of the screw stop can result in temperatures higher than 115°F (46°C). After completing repairs, check maximum discharge temperature (115°F [46°C]). Reset if necessary.

REPAIR KITS

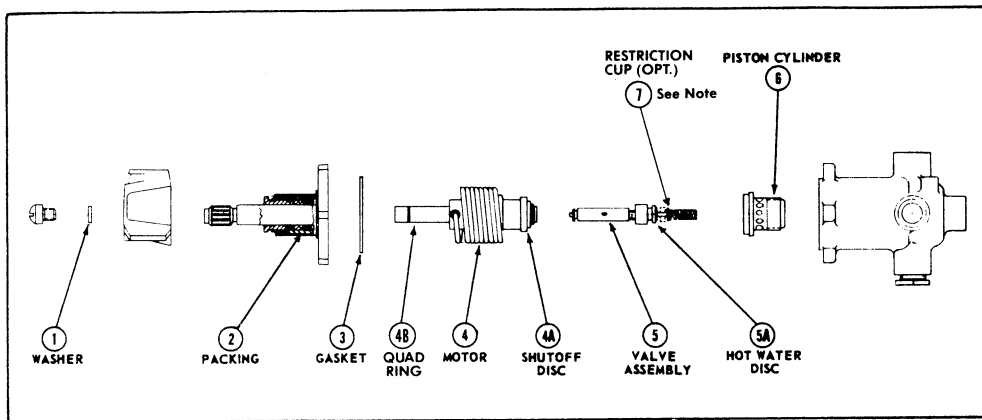

TROUBLE SHOOTING		Recommended Repair Kit
GASKET AND DISC REPLACEMENT	1. Water leak at stem and/or bonnet 2. Flow of water continues after mixer is turned off	225-357 Includes items: 1, 2, 3, 4A, 4B and 5A
VALVE AND CYLINDER REPLACEMENT	3. Variable or untempered discharge temperature (Lime deposits can be removed with the use of various commercially available products designed for this purpose.)	(5 GPM) 225-392* [0.32 l/s] (10 GPM) 225-393* [0.64 l/s] (15 GPM) 225-394* [0.95 l/s] Includes items: 3, 5, 5A, 6 and 7
MOTOR REPLACEMENT	4. If items 5 and 6 are free of lime and free-moving and discharge temperature is variable or untempered	(40–90F) 225-397 (4 to 32°C) (65–115F) 225-395 (18 to 46°C) (75–175F) 225-396 (24 to 79°C) Includes items: 3, 4, 4A and 4B
	5. If mixer has a serial number of 1946 or under, complete replacement of internal parts are required	(5 GPM) 225-391 [0.32 l/s] (10 GPM) 225-390 [0.64 l/s] Includes all items except body, dial & handle

For easy removal of piston cylinder (Item 6) order special wrench, part No. 225-350.

For parts not covered above, refer to Technical Instruction Form MV 427 - 1.

NOTE: To add motor failure protection to standard mixer, install hot water restriction cup to valve assembly. To install, remove screw from disc holder, insert screw into open end of cup and rescrew cup/screw to disc holder.

Caution: motor failure protection should NOT be used in conjunction with a downstream shut-off valve. Cup will prevent proper operation.

*** The valve assembly (5) and cylinder (6) must both be replaced at the same time when using this kit. Do not use the new valve assembly with an old cylinder, or vice versa. Torque piston cylinder to 20-35 ft.-lbs. do not overtighten!**