

**MODEL NUMBERS
EDFP-19-A
(ADA COMPLIANCE/QUICK DISCONNECT FITTINGS)**

Item No.	Part No.	Description
1	21222-C	Basin — 1-Hole
	21223-C	Basin — 1-Hole — Bronzitone
2	40038C	Tailpipe Strainer
	40111C	Tailpipe Strainer — Bronzitone
3	40573C	Tailpipe Ferrule
	40574C	Tailpipe Ferrule — Bronzitone
4	50074-C	Tailpipe Gasket
5	40129-C	Tailpipe
6	20415-C	Basin Hanger Strap
7	22905C*	Side Panel — Left Hand
	22906C*	Side Panel — Left Hand — Bronzitone
8	22907C*	Side Panel — Right Hand
	22908C*	Side Panel — Right Hand — Bronzitone
9	50123-C	Panel Bumper
10	90674-C	Insert — Handicap
11	20998-C	Angle—Brace
12	40690000	Rivet
13	89099000	Foam Tape
14	21560-C	Access Panel
15	34783003	Washer — Star #10
16	70294-C	Screw #10 x .50 Phillips Head
17	22714C*	Front Panel — Bronzitone
	22718C*	Front Panel
18	50079-C	Panel Bumper
19	21292-C	Lever Push
20	50198-C	Bushing — Nylon
21	50036-C	Bumper
22	70055-C	Speed Clip
23	70283-C	Clip
24	70788-C	Y-Strainer

Item No.	Part No.	Description
25	50985C	Holder — Regulator Assembly
26	60001-C	Regulator — Alt.
	61314-C	Regulator — Prim.
27	10031-C	Retaining Nut
28	40045-C	Hex Nut
29	70278-C	Rod — Pivot
30	21711-C	Base
31	40107001	Screw
32	21710-C	Angle — Wall Mtg.
33	70012-C	Locknut
34	21417-C	Pushbar
	21398-C	Pushbar — Bronzitone
35	70300-C	Rivet
36	51349-C	Bubbler Assembly
	51350-C	Bubbler Assembly — Bronzitone
37	50168-C	Pedestal
	50373-C	Pedestal — Bronzitone
38	70208-C	Screw #10-24 x .37 Phillips Head
	70209-C	Screw #10-24 x .37 Phillips Head — Bronzitone
39	40322-C	Orifice Assembly
	40066-C	Orifice Assembly — Bronzitone
40	50934-C	Guard

*Panels measure 7 1/4" top to bottom.
For panels measuring 7 3/4", see page 4.1.6.

Product may be manufactured under U.S. Patent No. 4,481,971

- NOTICE:**
THIS WATER COOLER MUST BE CONNECTED TO THE WATER SUPPLY USING A DIELECTRIC COUPLING. THE COOLER IS FURNISHED WITH A NON-METALLIC Y-STRAINER WHICH MEETS THIS REQUIREMENT.

THE DRAIN TRAP WHICH IS PROVIDED BY THE INSTALLER SHOULD ALSO BE PLASTIC TO COMPLETELY ISOLATE THE COOLER FROM THE BUILDING PLUMBING SYSTEM.
- ACTUATION OF QUICK CONNECT WATER FITTINGS:**
COOLER IS PROVIDED WITH LEAD-FREE CONNECTORS WHICH UTILIZE AN O-RING WATER SEAL TO REMOVE TUBING FROM THE FITTING, RELIEVE WATER PRESSURE, PUSH IN ON THE GRAY COLLAR WHILE PULLING OUT ON THE TUBING. TO INSERT TUBING, PUSH TUBE STRAIGHT INTO FITTING UNTIL IT REACHES A POSITIVE STOP, APPROXIMATELY 3/4 INCH. SEE DETAIL C
- CONNECTING LINES TO BE OF COPPER, THOROUGHLY FLUSHED TO REMOVE ALL FOREIGN MATTER BEFORE CONNECTING TO COOLER
- CONNECT COOLER TO BUILDING SUPPLY LINE WITH A SHUT-OFF VALVE AND INSTALL 3/4" WATER LINE BETWEEN THE VALVE AND COOLER. REMOVE BURR FROM OUTSIDE OF WATER LINE. LOOSEN NUT ON INLET SIDE OF Y-STRAINER AND INSERT WATER LINE TO POSITIVE STOP APPROXIMATELY 3/4 INCH. FINGER TIGHTEN NUT TO LOCK TUBING IN PLACE

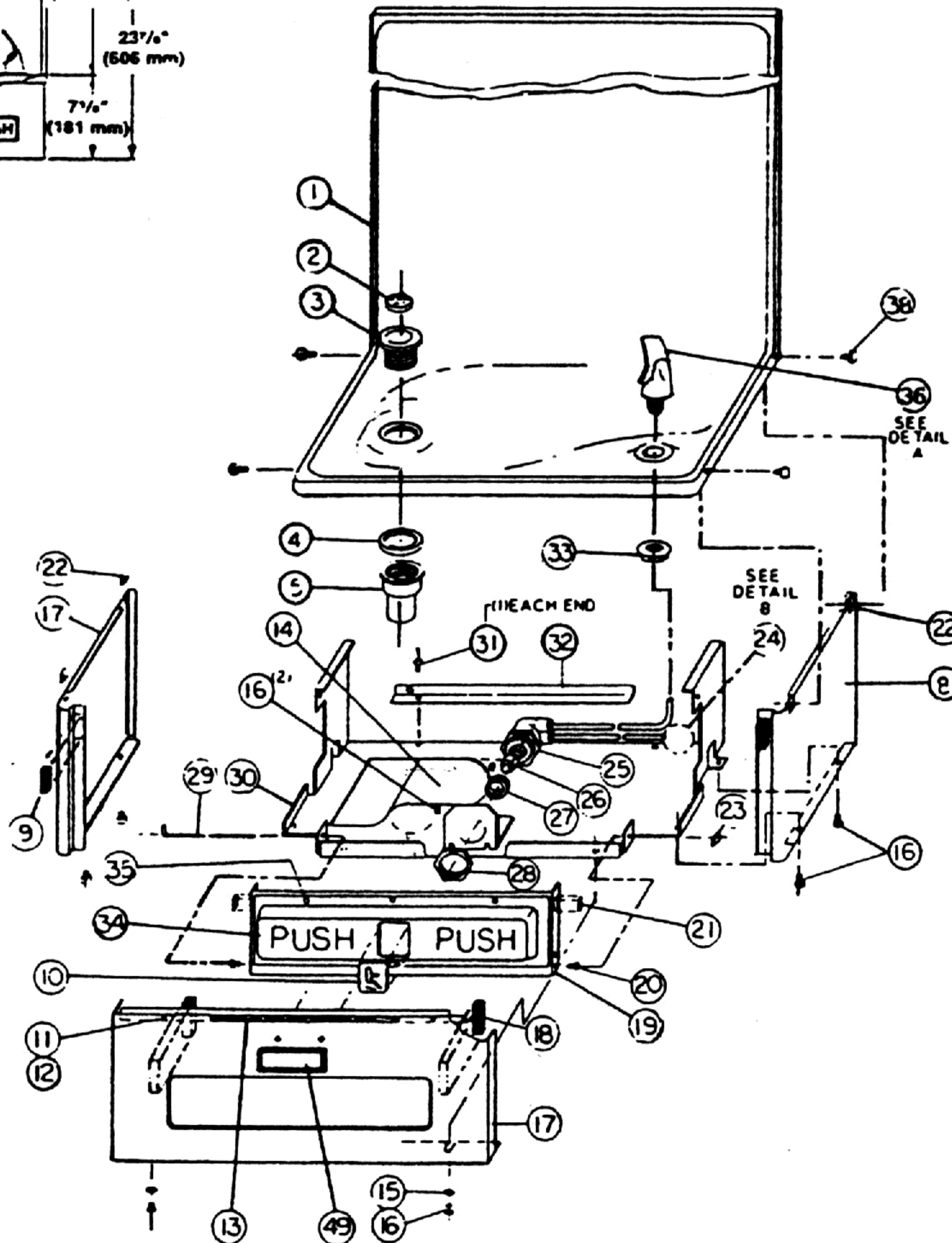
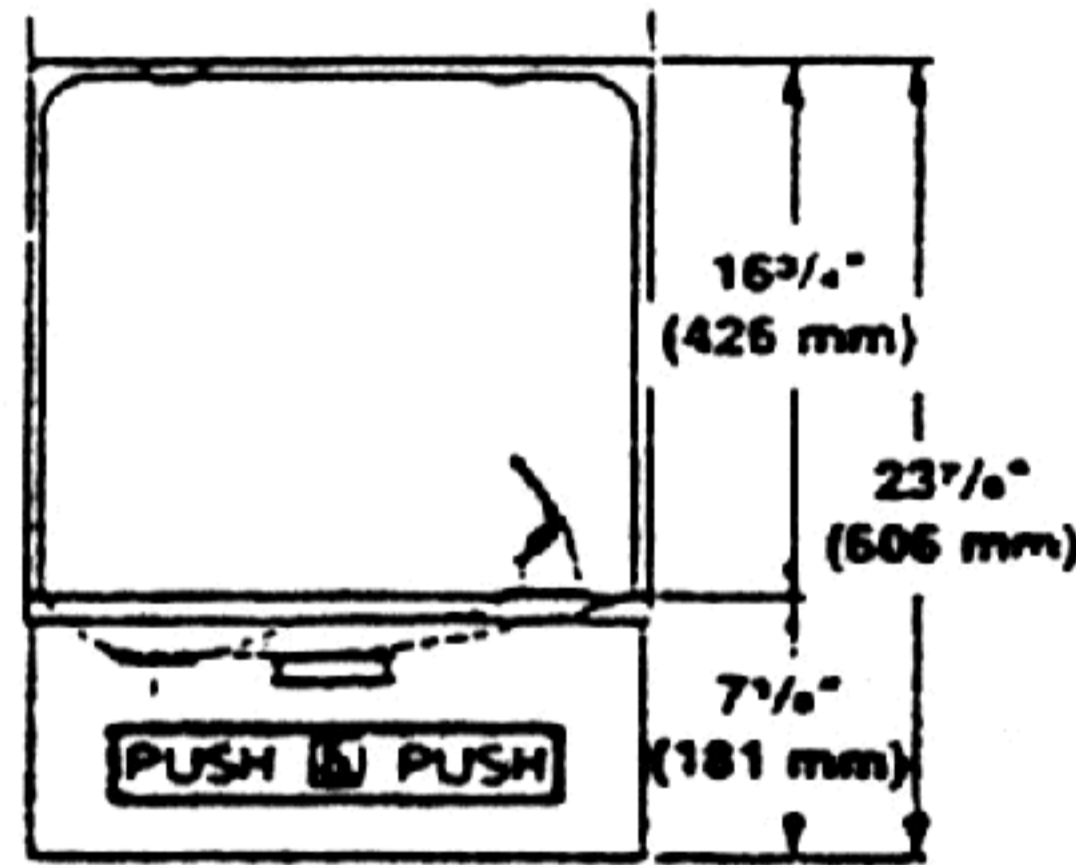

FIGURES C THRU F ILLUSTRATE THE COMPONENTS HAVING QUICK CONNECT FITTINGS

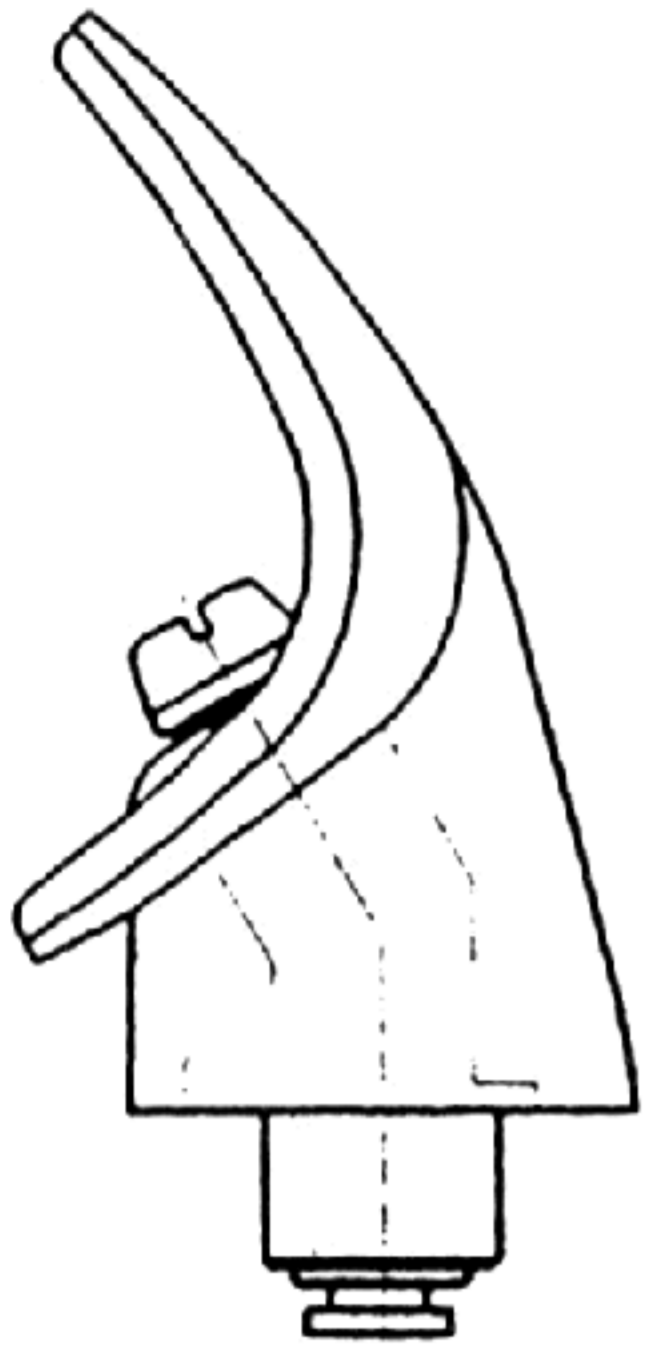

FIG. C

BUBBLER HOUSING ASSY #51349C (COMPLETE AS SHOWN)

BUBBLER REPLACEMENT KIT #92715C (INCLUDES #51349C & ONE 5 INCH PIECE OF 1/4 INCH COPPER TUBE. THIS KIT IS USED TO REPLACE BRASS BUBBLERS.)

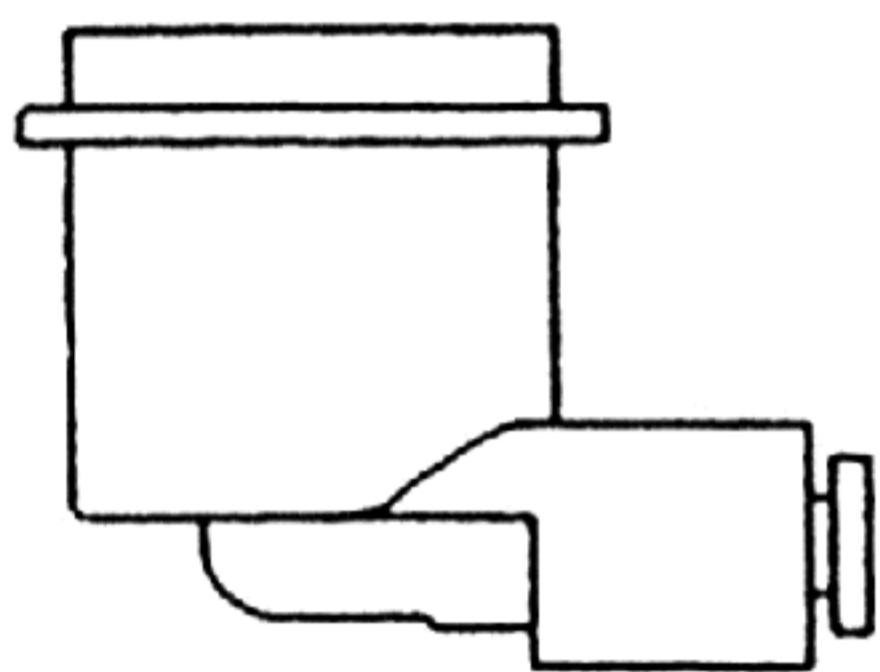

FIG. D

REGULATOR HOLDER #50985C (AS SHOWN)

REGULATOR HOLDER KIT #92450C (INCLUDES TWO 5 INCH PIECES OF 1/4 INCH COPPER TUBE. THIS KIT CAN BE USED TO REPLACE BRASS REGULATOR HOUSINGS.)

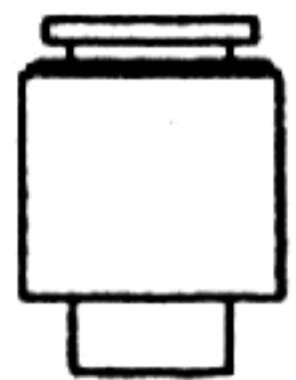

FIG. E

DRAIN PLUG #70606C (1/4" DRAIN PLUG FOR HEATER TANK)

DRAIN PLUG #70772C (3/8" DRAIN PLUG FOR EVAPORATOR TANK)

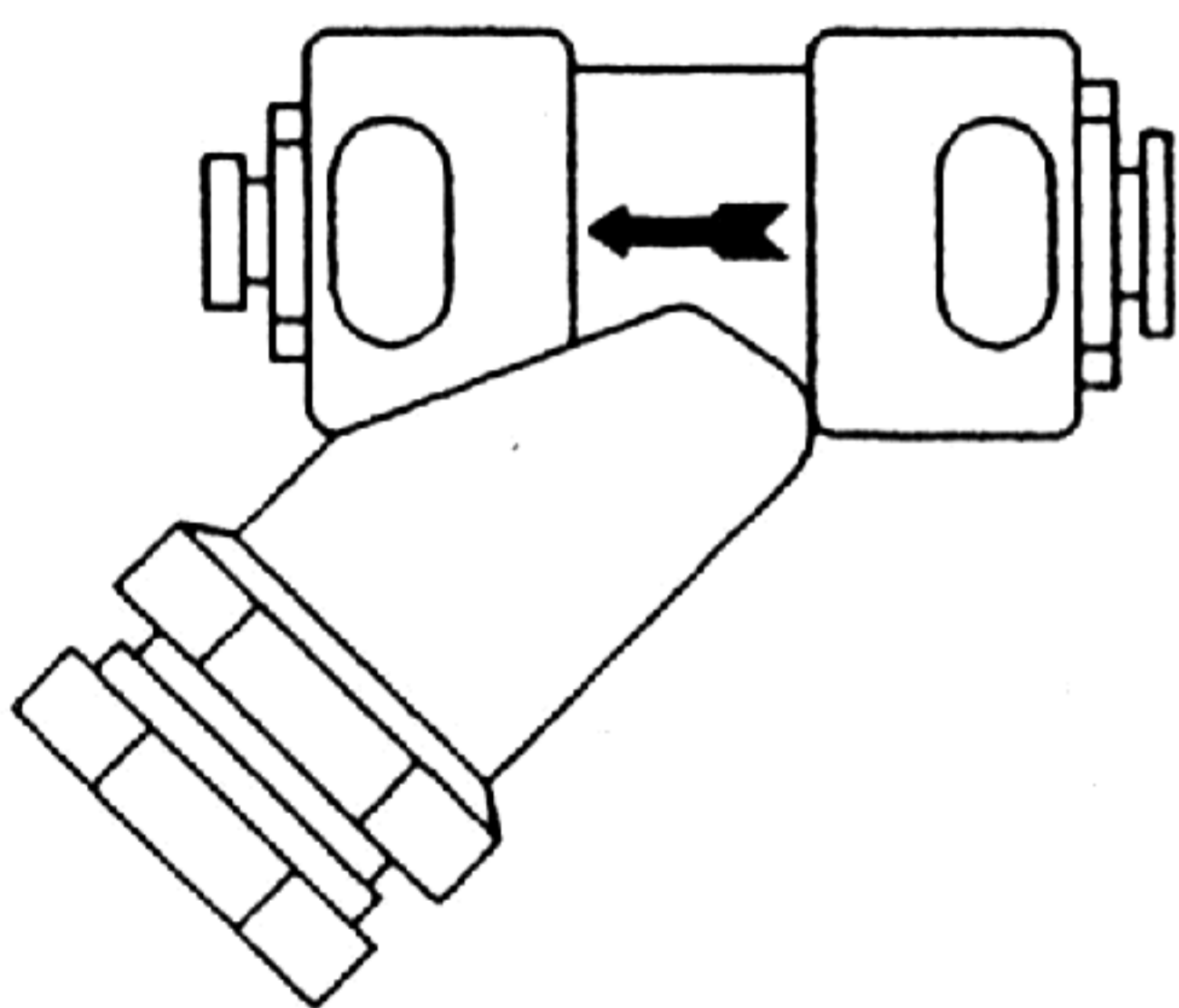
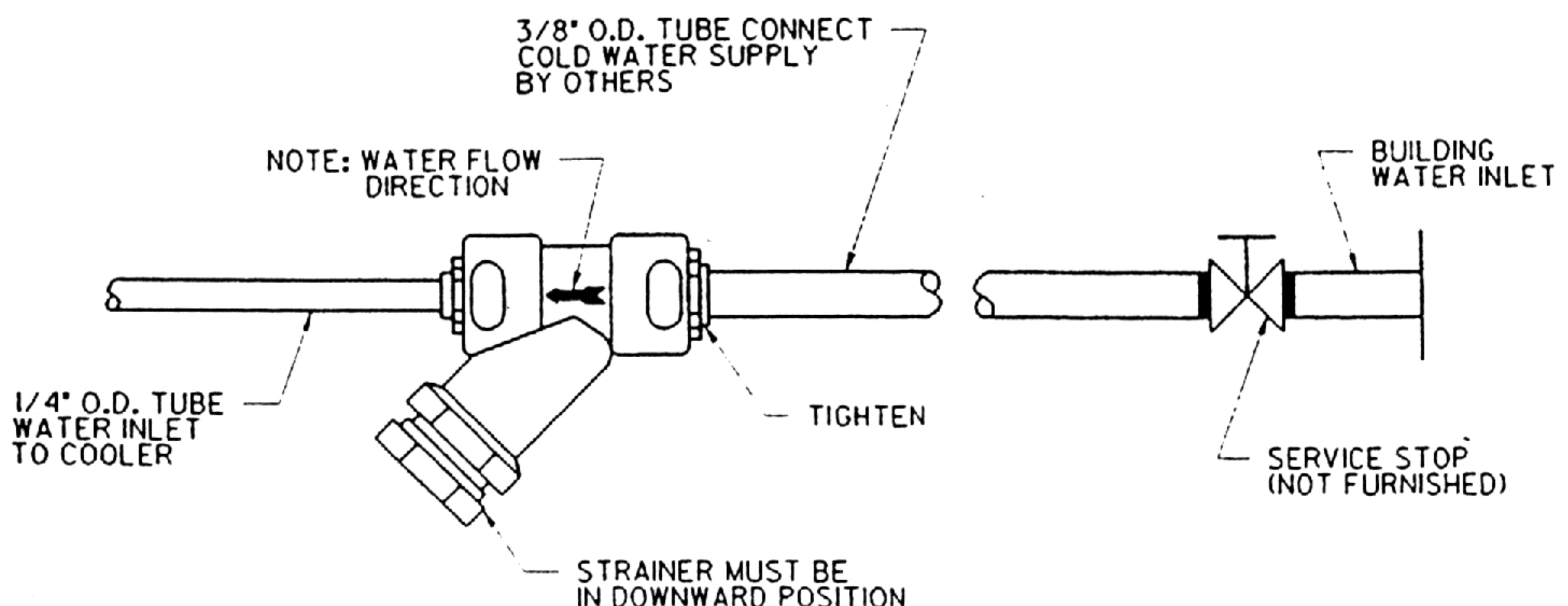
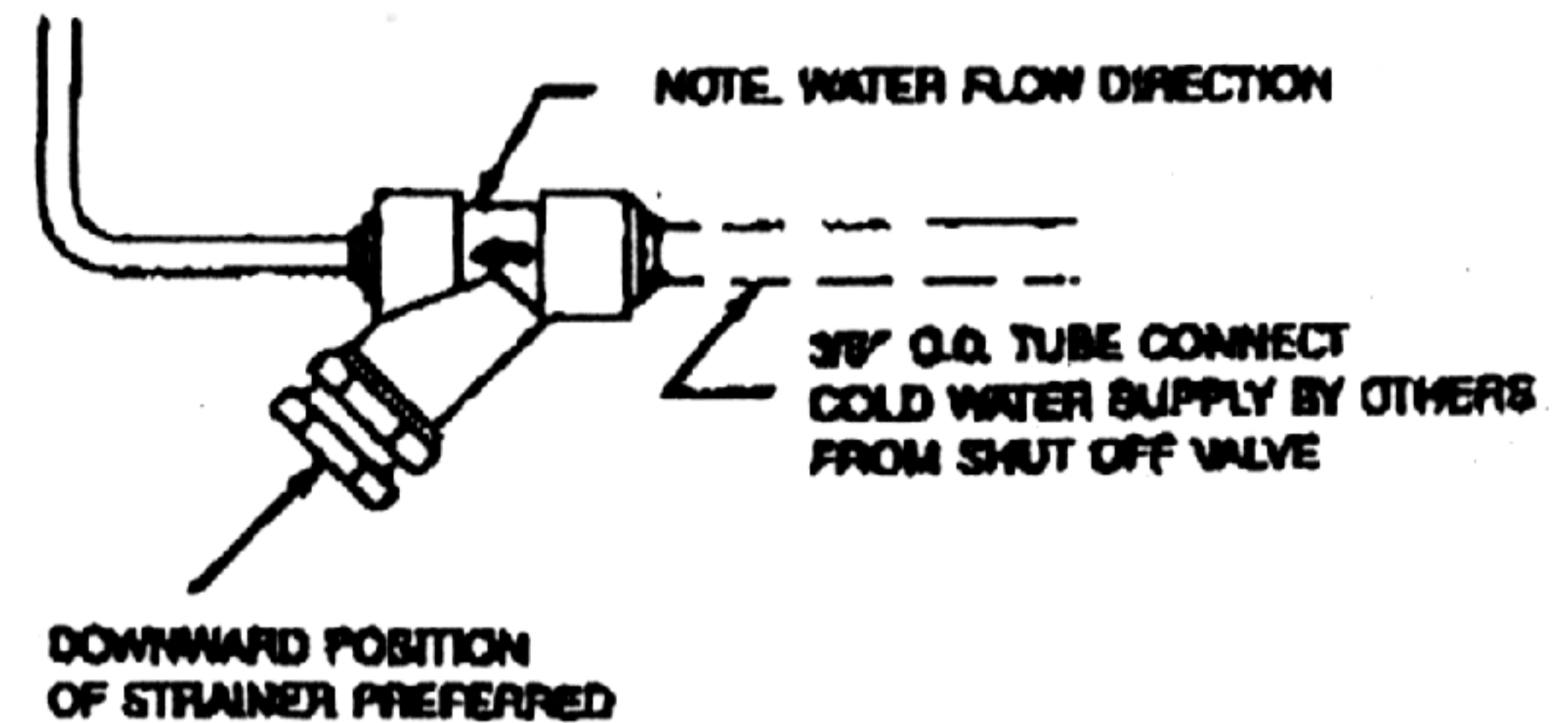
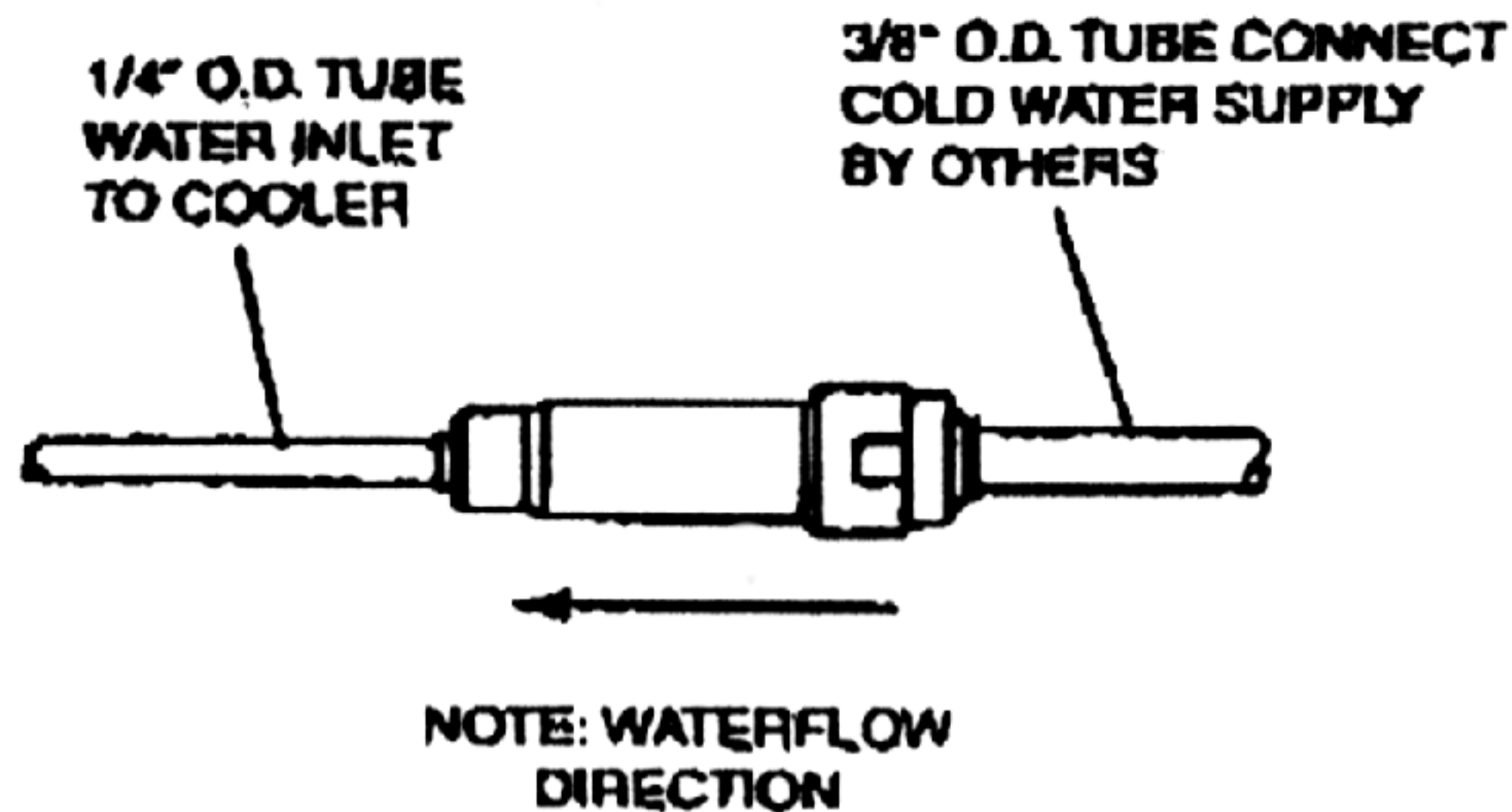

FIG. F

Y-STRAINER #70788C (3/8" WATER INLET & 1/4" WATER OUTLET)

Y-STRAINER INSTALLATION





New Strainer, P/N 55996C

Old Strainer, P/N 70788C

strainer (pictured below) will directly replace the old y-strainer, part # 70788C.

In-Line Strainer, 55996C

1. Dirt and sediment are captured on the outside surface of the screen. This increases the ease of cleaning the new screen.
2. Larger surface area of strainer provides greater opportunity to capture dirt and sediment.
3. Symmetric design eliminates the need for orientation of the strainer. This eases installation and allows peak performance independent of the strainer orientation.