

*Halsey Taylor.*

To order items on this page — full catalog number requires prefix

**H / T**

**ASSEMBLIES**

PROJECTOR – 10-03041-51-640		
REF NO	PART NUMBER	DESCRIPTION
1	10-14884-51-550	Cartridge
2	10-14875-43-890	Hex Cover
3	10-14874-31-640	Push Button
4	10-14860-43-890	Retaining Nut
5	16-03564-08-540	Spout
6	10-14877-43-550	Screen
7	10-03227-40-560	Gasket Spanner Wrench

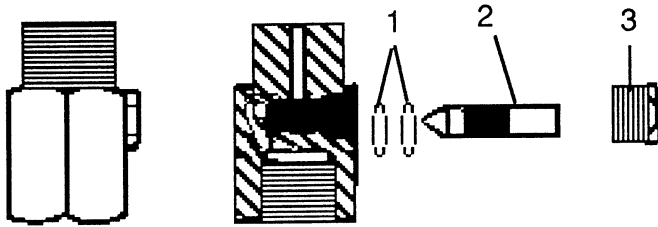

SERVICE VALVE ASSEMBLY – 60-09414-51-640		
REF NO	PART NUMBER	DESCRIPTION
1	10-26722-40-560	O-Ring Packing (2 each)
2	11-02238-08-820	Regulating Screw
3	16-02239-08-550	Gland Packing

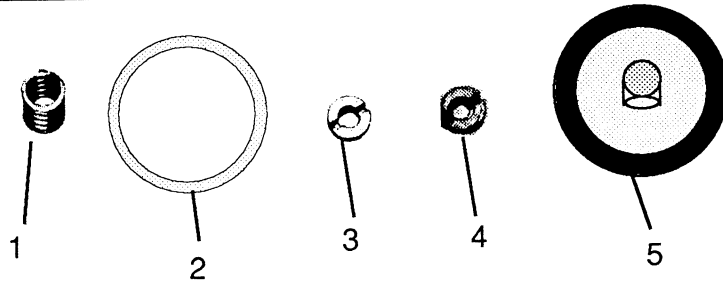

VALVE REPAIR KIT – 60-08050-51-550		
REF NO	PART NUMBER	DESCRIPTION
1	11-00911-35-550	Spring
2	11-42257-42-550	Washer
3	16-14755-08-550	Bushing (Brass Regulator)
4	16-42251-16-550	Bushing (Plastic Regulator)
5	60-14757-51-550	Diaphragm Assembly

VALVE SEAL KIT – 92445C		
REF NO	PART NUMBER	DESCRIPTION
1	10-03302-40-560	Sleeve Seat Washer
2	10-06026-40-560	Seat Washer
3	10-08211-40-560	O-Ring
4	10-14203-40-550	O-Ring
5	11-42258-42-550	Sleeve Washer
6	11-42440-42-550	Spring Valve
7	11-42264-42-550	Seat Washer Screw
8	16-42255-16-550	Retaining Cup
9	35000510	Lubricant

