

DRAIN ROOTER

Parts List and Diagrams

CAT. NO.	DESCRIPTION	CAT. NO.	DESCRIPTION
DR-100	Frame Complete for Black & Decker Motor	DR-201	Container Front with Spindle
DR-100-1	Frame Complete for Skil Motor	DR-201-A	Screws and Clips (3)
DR-101	Frame Only for B&D Motor	DR-202	Container Back
DR-101-1	Frame Only for Skil Motor	DR-204	Hub for B&D Motor
DR-101-A	Bushing (2)	DR-204-1	Hub for Skil Motor
DR-102	Rubber Leg Tips (2)	DR-204-A	Set Screw
DR-104	Shaft Retaining Pin for B&D Motor	DR-205	Screws and Nuts for Hub (5)
DR-104-1	Drum Retaining Latch for Skil Motor	DR-206	Internal Ring Gear for Skil Motor
DR-104-A	Drum Latch Cap	DR-207	Shim
DR-105	Retaining Pin Spring for B&D Motor	DR-210	Container Shaft for B&D Motor
DR-105-1	Retaining Latch Spring for Skil Motor	DR-210-A	Roll Pin
DR-106	Retaining Pin Collar with Cap Screw for B&D Motor	DR-215	Collar
DR-106-1	Retaining Latch Support Bracket for Skil Motor	DR-225	Chuck
DR-107	Nuts, Bolts, & Washers (2)	DR-200-O	Open Cage for B&D Motor
DR-108	Switch Actuator Assembly for B&D Motor	DR-200-1-O	Open Cage for Skil Motor
DR-108-1	Switch Actuator Assembly for Skil Motor	DR-251	Cage Only for B&D Motor
DR-108-A	Switch Support Bracket	DR-251-1	Cage Only for Skil Motor
DR-108-B	Foot Pedal and Hose	DR-252	Cable Retaining Spring
DR-108-C	Cable Tie	DR-253	Retaining Nut
DR-108-D	Foot Pedal	DR-254	Washer
DR-108-E	Switch Actuator with Piston for B&D Motor	DR-260	Open Cage Shaft for B&D Motor
DR-108-1-E	Switch Actuator with Piston for Skil Motor	DR-260-A	Roll Pin
DR-108-F	Hose	DR-225	Chuck
DR-108-G	Nut, Bolt, and Washer for Bracket	DR-300	B & D Drill Motor
DR-108-H	Clamp and Screw	DR-300-1	Skil Motor Assembly
DR-200	Container Complete for B&D Motor	DR-M-S	Skil Motor Only
DR-200-1	Container Complete for Skil Motor	DR-301	Bolts & Washers for B&D Motor
		DR-301-1	Bolts & Nuts for Skil Motor
		DR-304	Power Cord for B & D Motor
		DR-304-1	Power Cord for Skil Motor
		DR-305	Gear Case Body for Skil Motor
		DR-305-A	Thrust Bearing
		DR-307	Pinion Gear Assembly for Skil Motor
		DR-310	Spacer Washer
		DR-315	Fillister Head Screws (4)
		DR-320	Variable Speed Trigger Switch for Skil Motor

General Wire Spring Co.

DRAIN ROOTER SCHEMATIC DIAGRAM

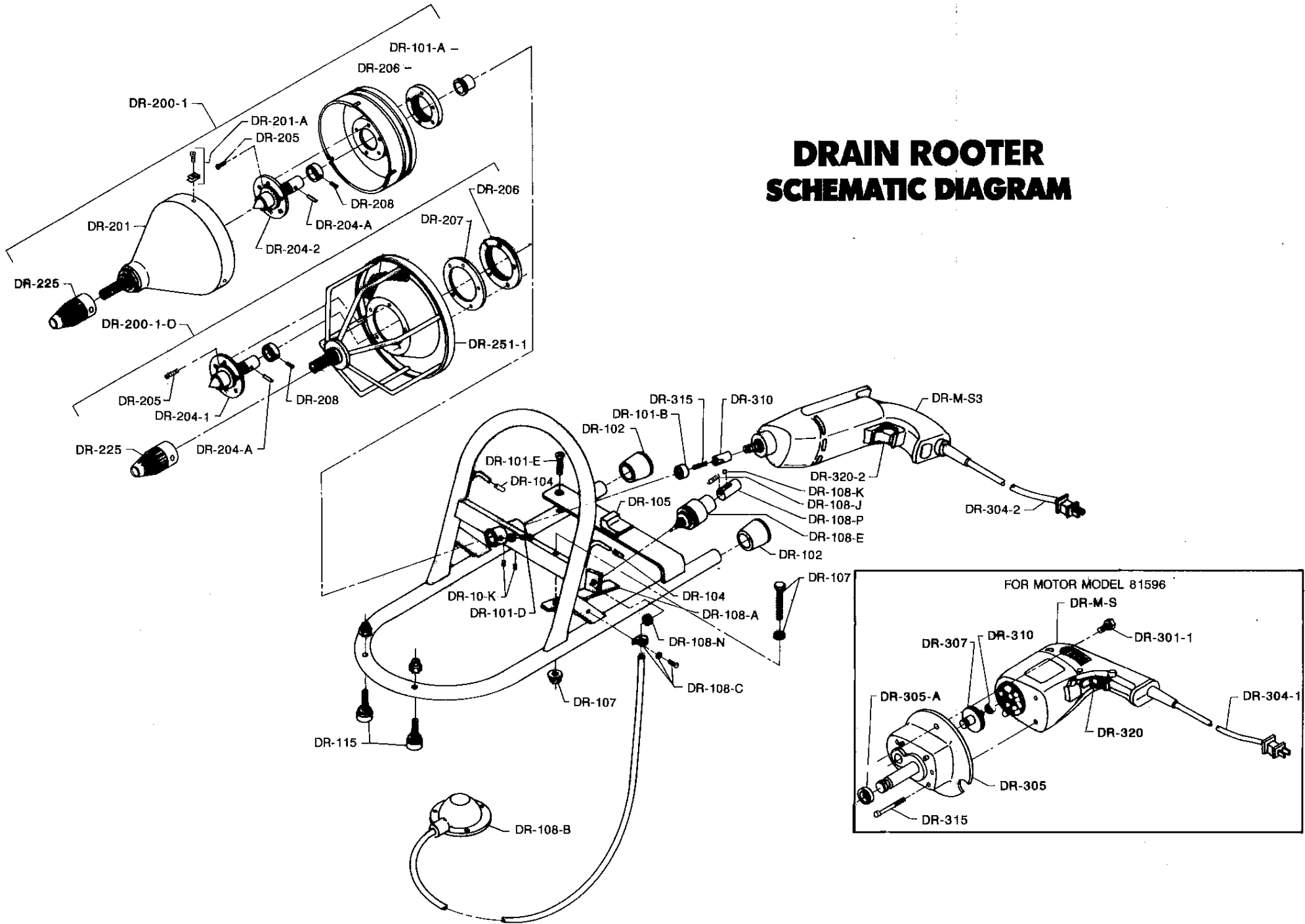

IMPORTANT: When ordering, give Serial Number of Machine